

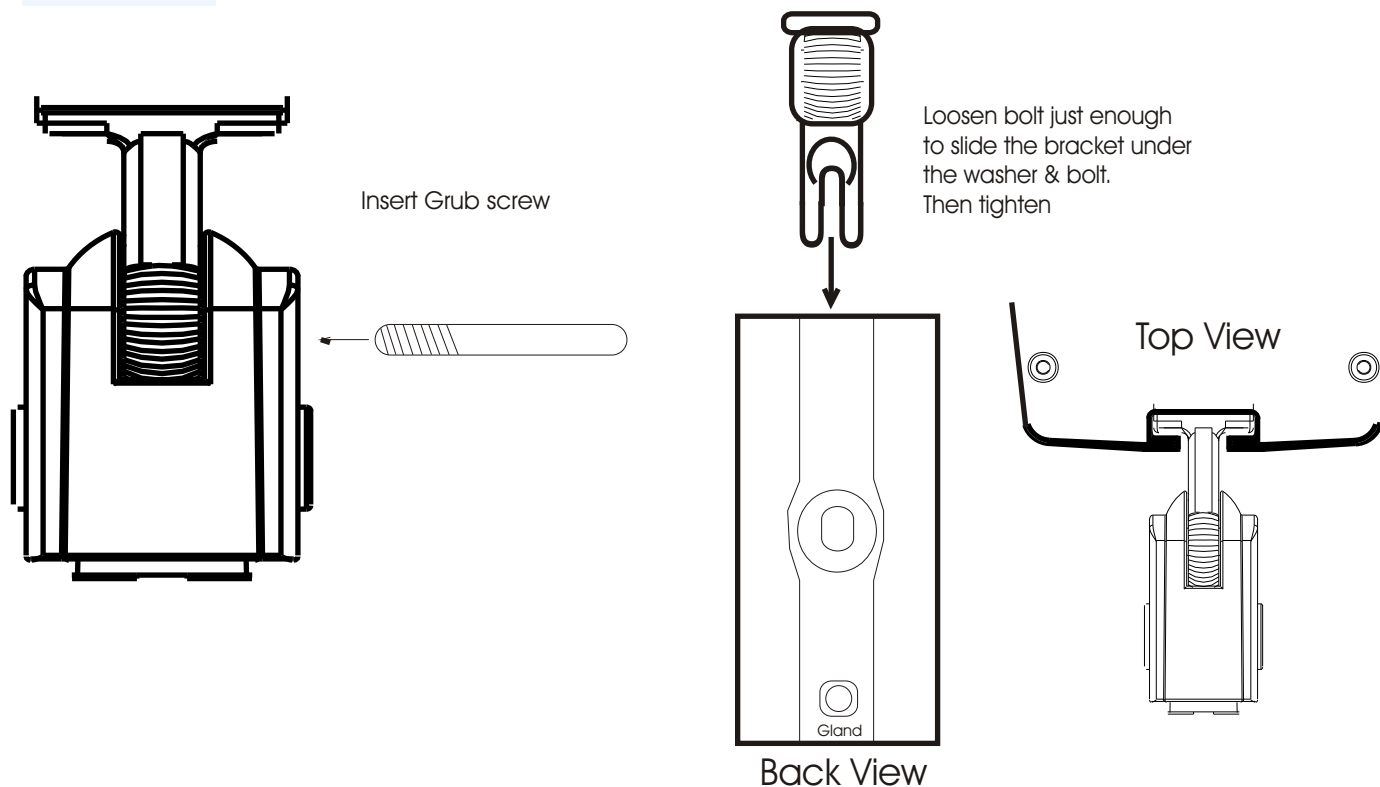

HIGH PERFORMANCE METAL COLUMN LOUDSPEAKER

MUS40/TC

Installation instructions



A. Wall mounting plate.

Drill the required fixing holes using the guide template in the back of the plate, then secure to a suitable surface

B. Fixing to the Wall Mounting plate.

Locate the MUS to wall plate, insert the retaining bolt, fit wing nut and tighten. Position the speaker as required.

C. Connections

Remove bottom plate, feed the cable through the gland and terminate to terminal block, refit plate and tighten the gland.

